



Buckeye Beach Park LLC
.....

Written Plan of
Protection from Local
Fire Department



Walnut Township Fire Dept.

Robert L. Price, Fire Chief
2435 Blacklick Eastern Rd NE
Millersport, Ohio 43046
(740) 467-7250 – Office (740) 467-0944 – Fax
www.walnutfire.com
bprice@walnutfire.com

Tuesday, April 09, 2024

To whom it concerns:

The Walnut Township Fire Department is funded by the citizens/taxpayers of Walnut Township in Fairfield County, Ohio. We provide Fire and EMS service to all areas and addresses in Walnut Township including all of Fairfield Beach.

We have three (3) fire stations in Walnut Township that are staffed with volunteers and part-time paid personnel. The addresses of the fire stations are as follows:

Station 631—2435 Blacklick-Eastern Rd NE, Millersport OH, 43046
Station 632---5400 Fairfield Beach Rd NE, Thornville OH, 43076
Station 633---8474 High Street, Thurston OH, 43157

If more information is needed, please contact me at the email address listed in the signature line.

Respectfully,

Robert L. Price
Fire Chief
Walnut Township Fire Department
firechief@walnutfire.com



Buckeye Beach Park LLC
.....

FEMA & Flood Hazard Certificate

**CERTIFICATION
FLOOD HAZARD AREA DETERMINATION**

CERTIFICATION NUMBER: 24-03
COMMUNITY PANEL NUMBER: 39045C0090G
MAP DATE: 1/6/2012
ZONE: X
CERTIFICATION FEE: \$10.00
CERTIFICATION DATE: MARCH 12, 2024

According to the Federal Emergency Management Agency (FEMA) Flood Hazard Maps, it has been determined that the property described as follows:

LOCATION: BUCKEYE BEACH MARINA INC.
5089 BATESON DR NE, THORNVILLE OH 43076

PARCEL ID: #0460034500

TOWNSHIP: WALNUT TOWNSHIP

Development is NOT located in an identified FEMA area of special flood hazard.

Please note that this certification does not imply that land outside the areas of special flood hazard areas will be free from flooding or flood damage. Larger floods can and will occur on rare occasions and flood heights can be increased by man-made or natural causes.

Joshua Hillberry

Regional Planner/Floodplain Administrator
Fairfield County Regional Planning Commission

Joshua J. Hillberry

Date: 3/12/2024

Certification Number: 24-03

Note: Federal regulations place the responsibility for determining if a property or structure is located in a flood hazard area with the lender; a determination by our agency does not relieve the lender from their responsibility in rendering an independent determination.

If this property is being considered for a development, a building and/or development permit is required by the political subdivision in which the property is located. If the property is located within Fairfield County, a building and/or development permit may be applied for at the office of the Fairfield County Regional Planning Commission.

National Flood Hazard Layer FIRMette



82° 29' 16" W, 39° 55' 25" N

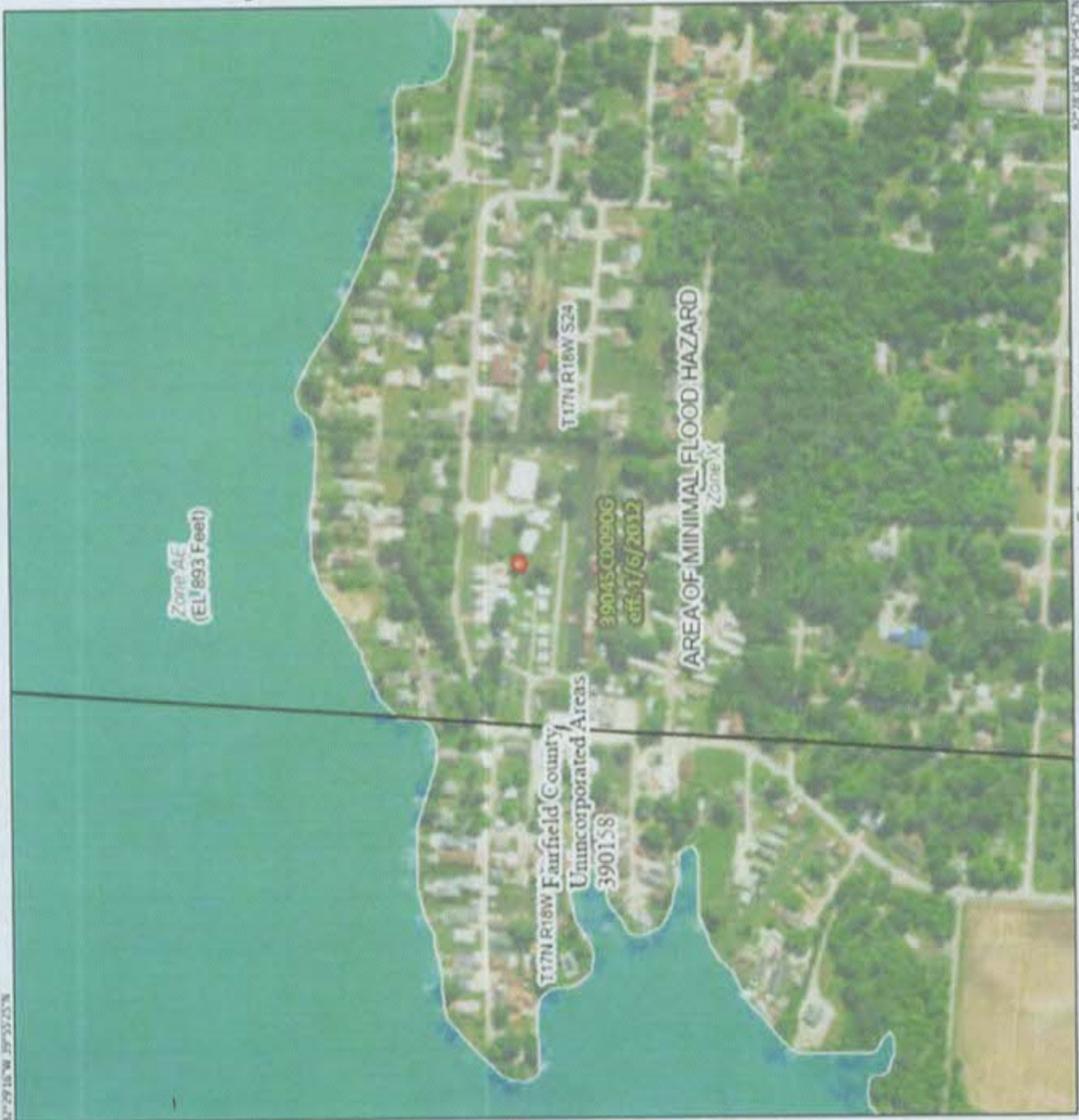

0 250 500 1,000 1,500 2,000 1:6,000 Feet

Basemap Imagery Source: USGS National Map 2023

Legend

SEE THIS REPORT FOR DETAILED LEGEND AND INDEX MAP FOR FIRM PANEL LAYOUT

SPECIAL FLOOD HAZARD AREAS

- Without Base Flood Elevation (BFE) *Zone A, C, AE*
- With BFE or Depth *Zone AE, AC, AH, VC, AP*
- Regulatory Floodway

OTHER AREAS OF FLOOD HAZARD

- 0.2% Annual Chance Flood Hazard. Areas of 1% annual chance flood with average depth less than one foot or with drainage areas of less than one square mile *Zone X*
- Future Conditions 1% Annual Chance Flood Hazard *Zone X*
- Area with Reduced Flood Risk due to Levee. See Notes. *Zone X*
- Area with Flood Risk due to Levee *Zone X*

OTHER AREAS

- NO SCREEN
- Area of Minimal Flood Hazard *Zone A*
- Effective LOMRs
- Area of Undetermined Flood Hazard *Zone B*

GENERAL STRUCTURES

- Channel, Culvert, or Storm Sewer
- Levee, Dike, or Floodwall

OTHER FEATURES

- Cross Sections with 1% Annual Chance Water Surface Elevation
- Coastal Transect
- Base Flood Elevation Line (BFE)
- Limit of Study
- Jurisdiction Boundary
- Coastal Transect Baseline
- Profile Baseline
- Hydrographic Feature

MAP PANELS

- Digital Data Available
- No Digital Data Available
- Unmapped

The pin displayed on the map is an approximate point selected by the user and does not represent an authoritative property location.

This map complies with FEMA's standards for the use of digital flood maps if it is not void as described below. The basemap shown complies with FEMA's basemap accuracy standards.

The flood hazard information is derived directly from the authoritative NFHL web services provided by FEMA. This map was exported on 3/12/2024 at 12:48 PM and does not reflect changes or amendments subsequent to this date and time. The NFHL and effective information may change or become superseded by new data over time.

This map image is void if the one or more of the following map elements do not appear basemap imagery, flood zone labels, legend, scale bar, map creation date, community identifiers, FIRM panel number, and FIRM effective date. Map images for unmapped and unmodernized areas cannot be used for regulatory purposes.

Parcel Map



3/12/2024, 2:59:38 PM

Roads

- County Roads
- Township Roads
- Private

County Boundary

Parcel Boundaries

Tract Lines

FEMA Flood Hazard Areas

- Waterbody
- 100yr Floodplain
- Streams

Scale: 1:9,028

0 0.05 0.1 0.2 mi

0 0.07 0.15 0.3 km

The user expressly agrees that the use of Fairfield County's data is at the user's sole risk.

Fairfield County Auditor Data Portal